

Front Grille Package Installation (Grille Insert Instruction ID: 84316279)

Installation Instructions Part Number

84316279

© 2024 General Motors. All rights reserved.



Kit Contents

Description	Qty
Front Grille Insert – Left	1
Front Grille Insert – Right	1
Front Grille Insert Emblem Adapter	1

Description	Qty
Installation Instructions	1

Tools Required

Side Cutters or equivalent

Plastic Trim Tool

Soft Mallet

Procedure

Remove Production Grille Inserts

- 1. Remove the front bumper fascia grille. Refer to [Front Grille Replacement](#) in Vehicle Service Manual.

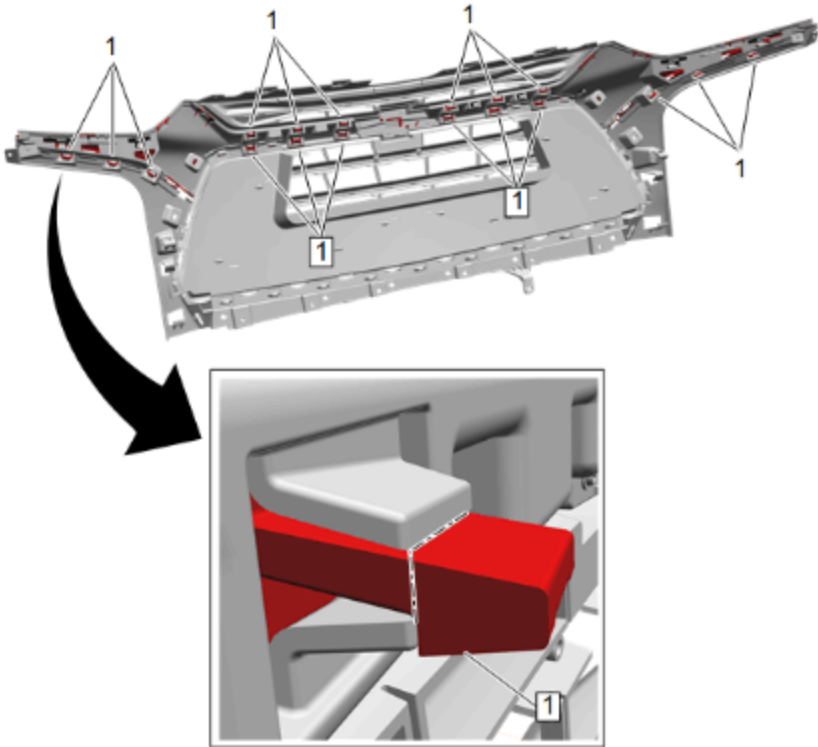

- 2. Place the front bumper fascia grille face down on a clean protective surface.

3. Using a suitable tool, clip the lower retaining tabs (1) according to the lines shown on the production grille insert.

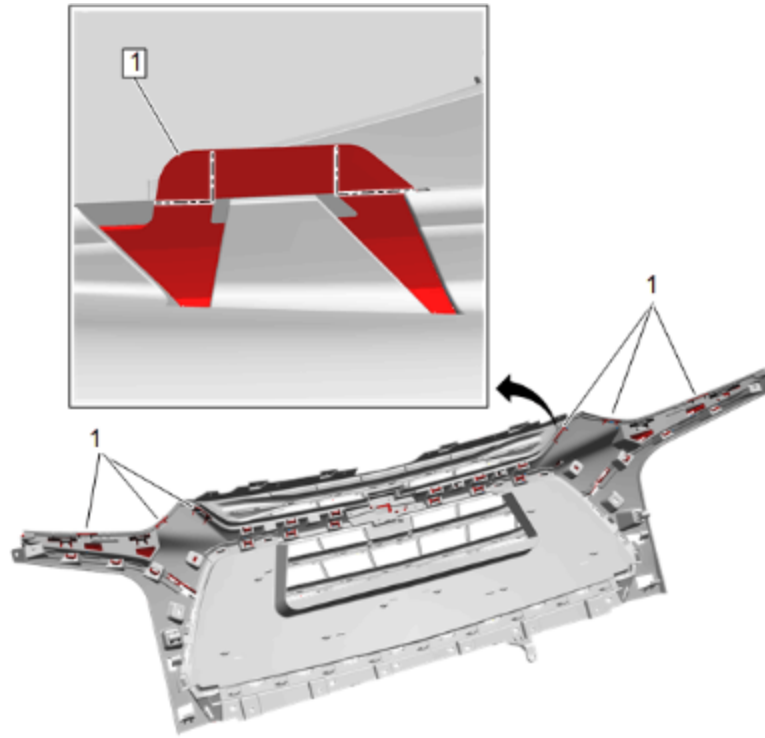

4. Using a suitable tool clip the sides of the upper retaining tabs (1) according to the lines shown on the production grille insert.

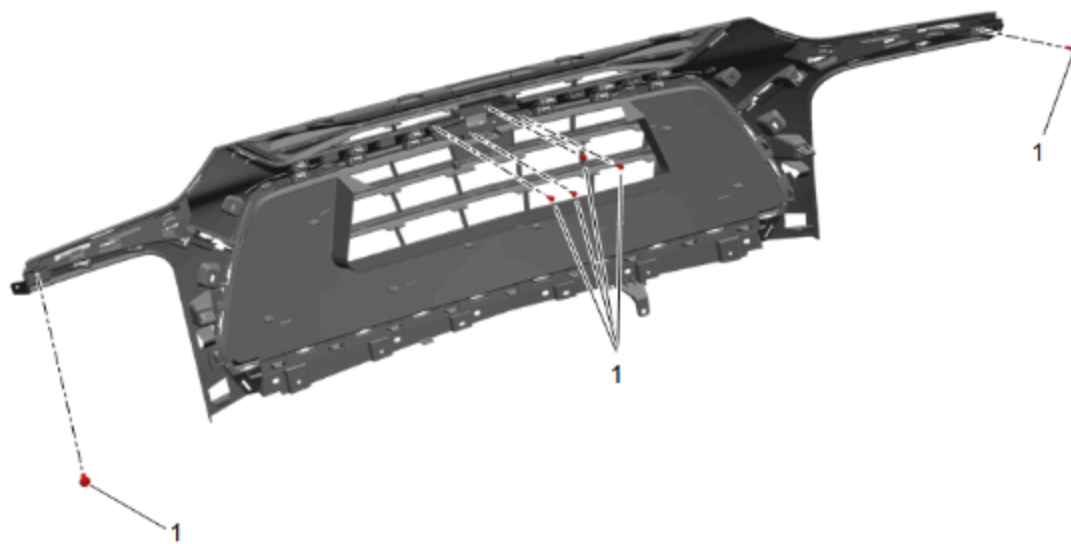

5. Remove and retain the screws (1) securing the production grille inserts to the grille.

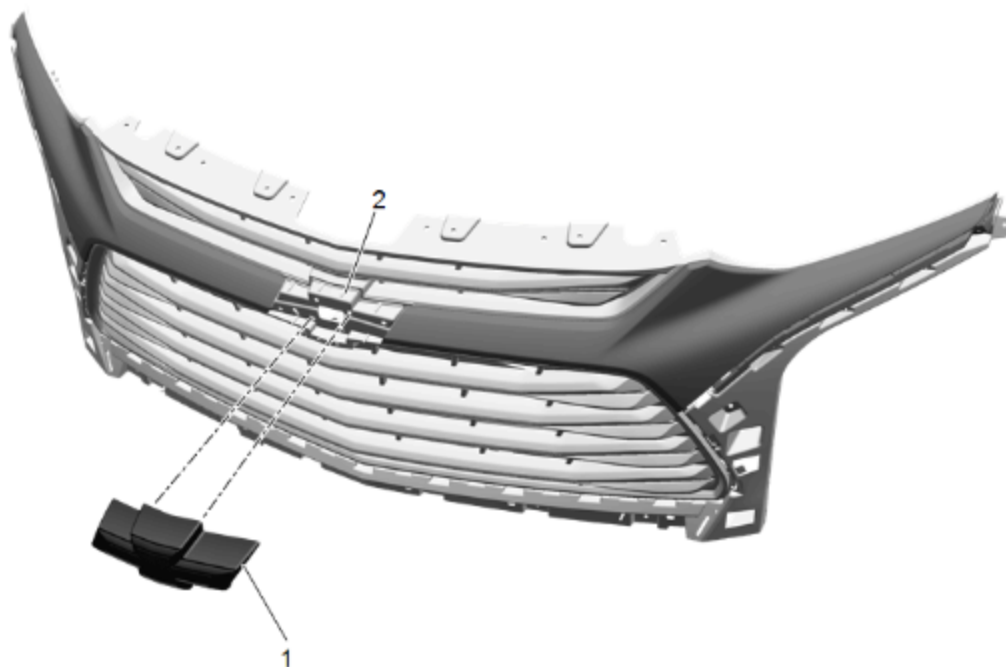

6. Pull forward and remove the front production grille insert emblem adaptor (1) from the front grille (2).

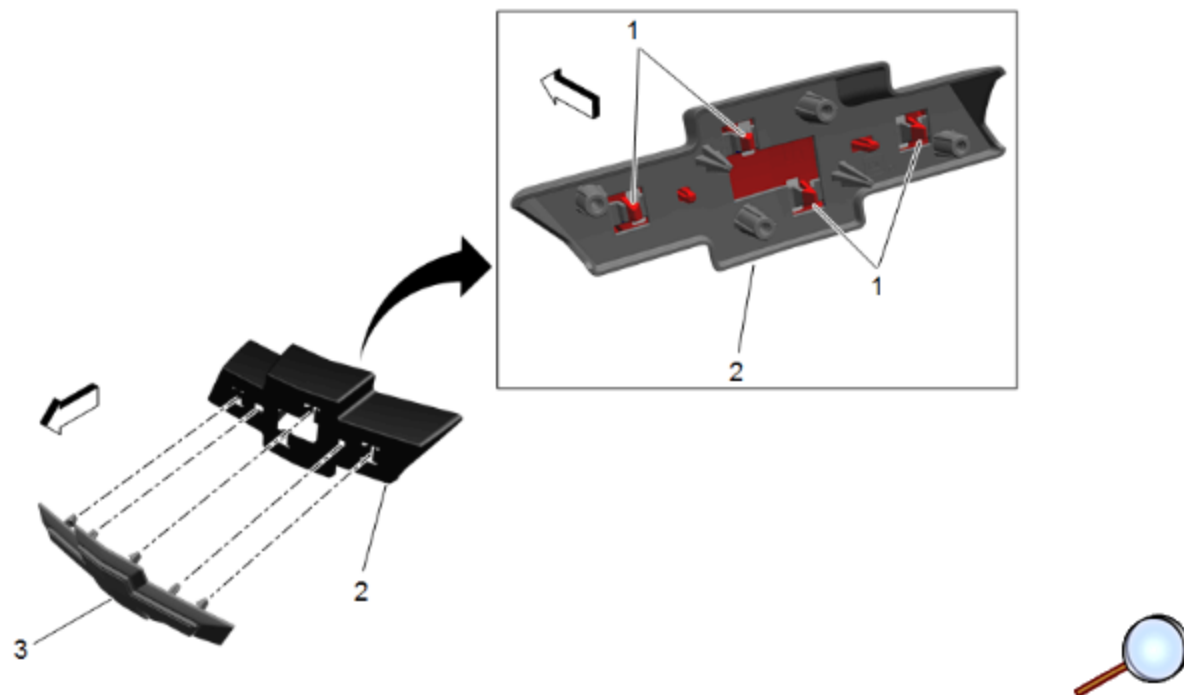

Note: Be careful not to damage bowtie emblem upon removal if being re-used.

7. Disengage the retaining tabs (1) and remove the bowtie emblem (3) from the production grille insert emblem adaptor (2).

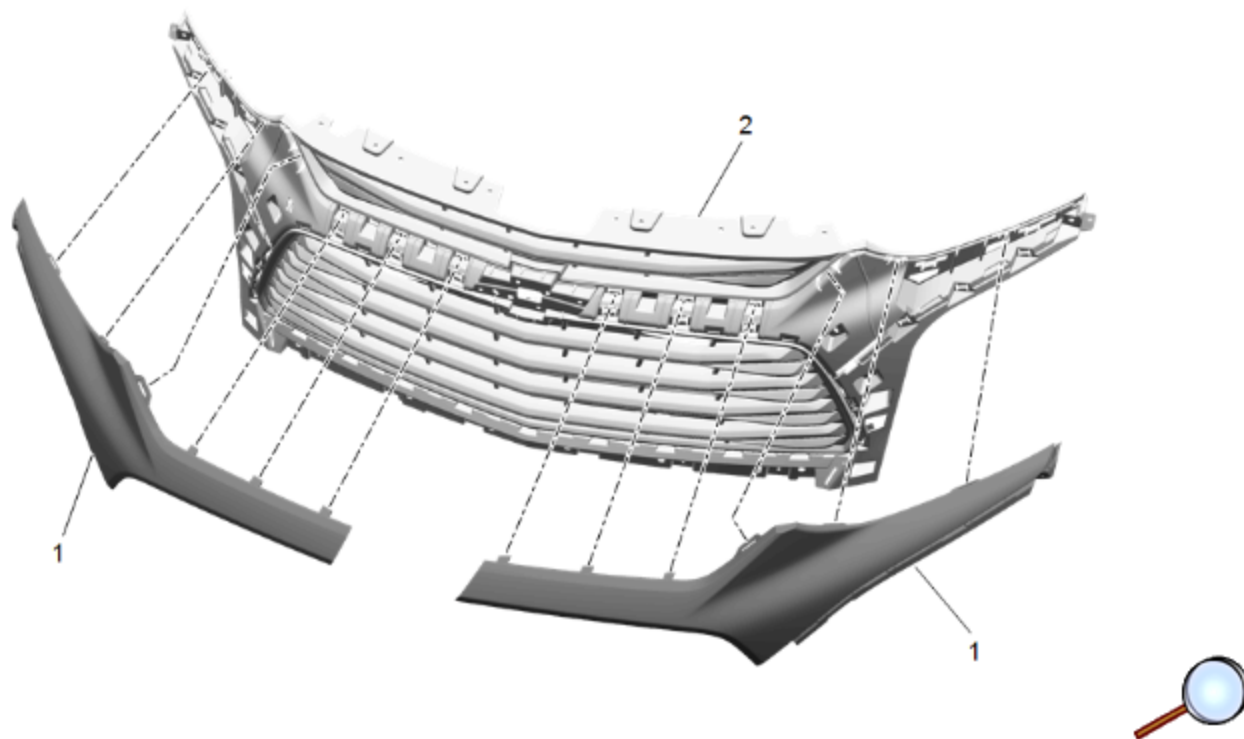

8. Pull forward and remove the front production grille inserts (1) from the front grille (2).

Install Accessory Grille Inserts

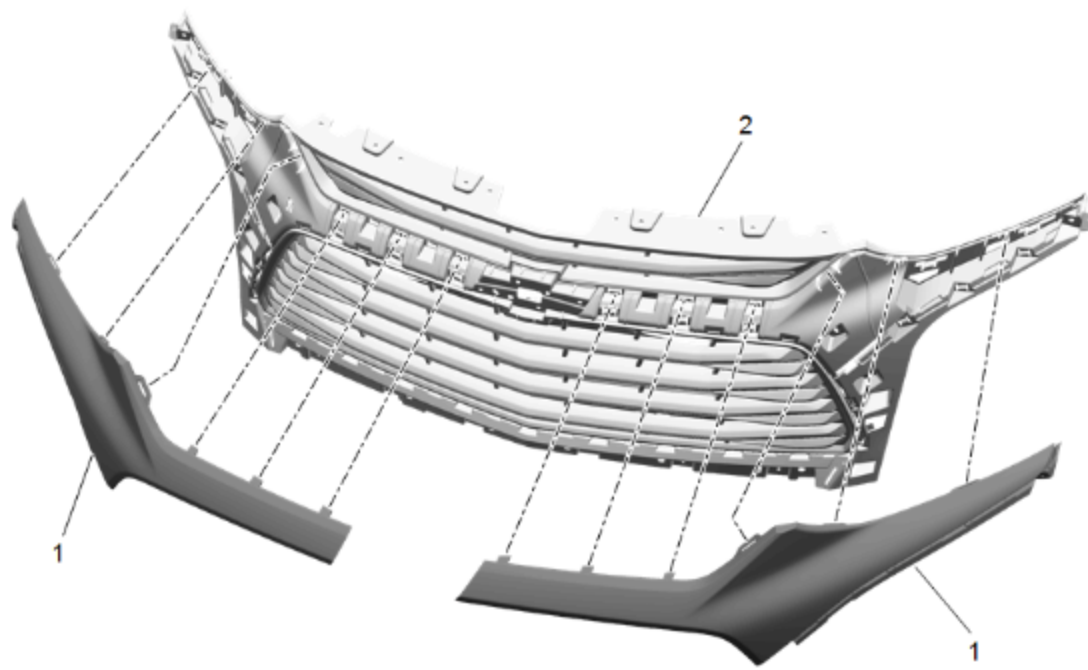

1. Position the grille inserts (1) to the front grille (2). Once the grille inserts (1) are positioned, place the front bumper fascia grille face down on a clean protective surface.

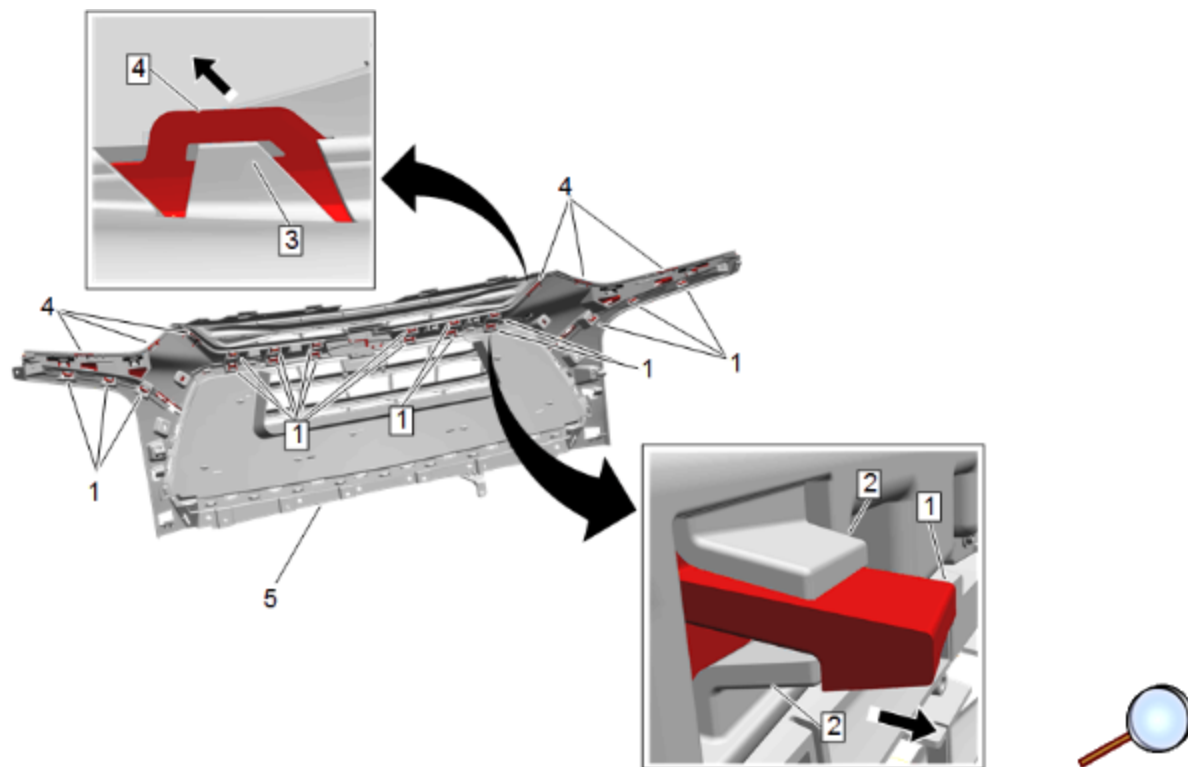

Note: The snaps (2) and grille insert lower retainers (1) will be difficult to engage manually, it is recommended to have the grille (5) face down on a clean protective surface with the aid of an assistant holding in position.

2. Using a trim tool and soft mallet, apply force to the unengaged snaps (2) to lock grille insert lower retainers (1) to the grille (5).
3. Engage the grille insert upper retainers (4) to the retaining tabs (3) on the grille (5).

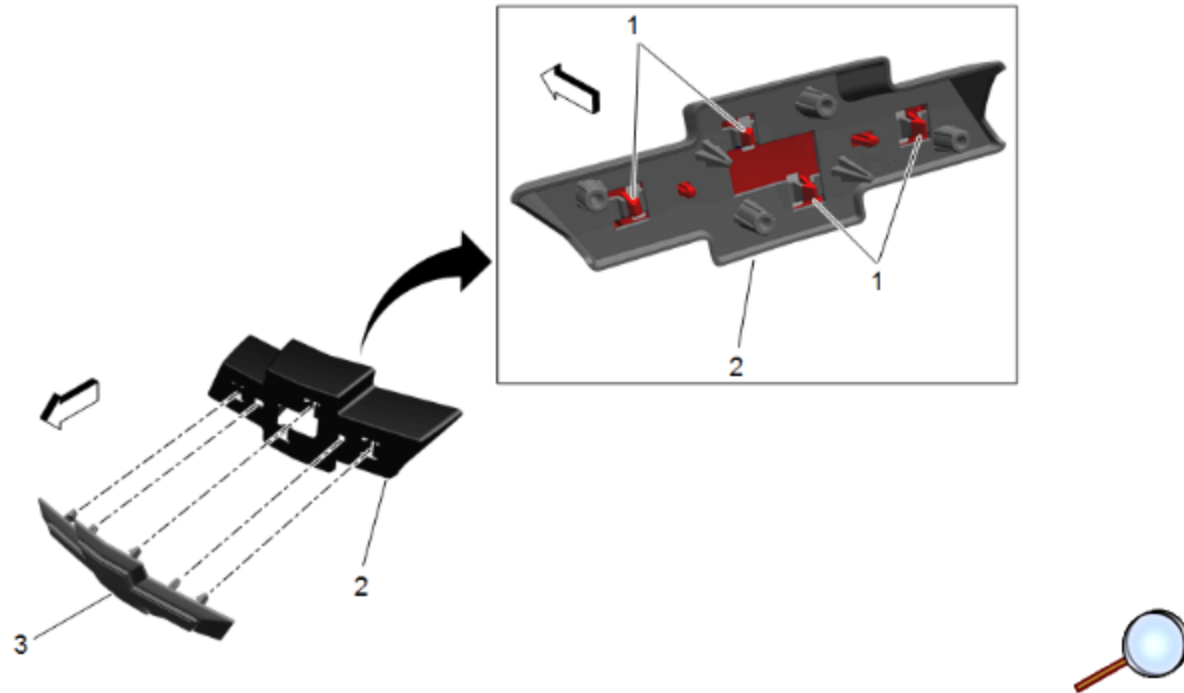

4. Install the bowtie emblem (3) to the grille insert emblem adaptor (2) engaging the retaining tabs (1).

Note:

- The bowtie can either be:
 - Re-used off the production grille.
 - Replaced with an accessory version:
 - Black
 - Illuminated

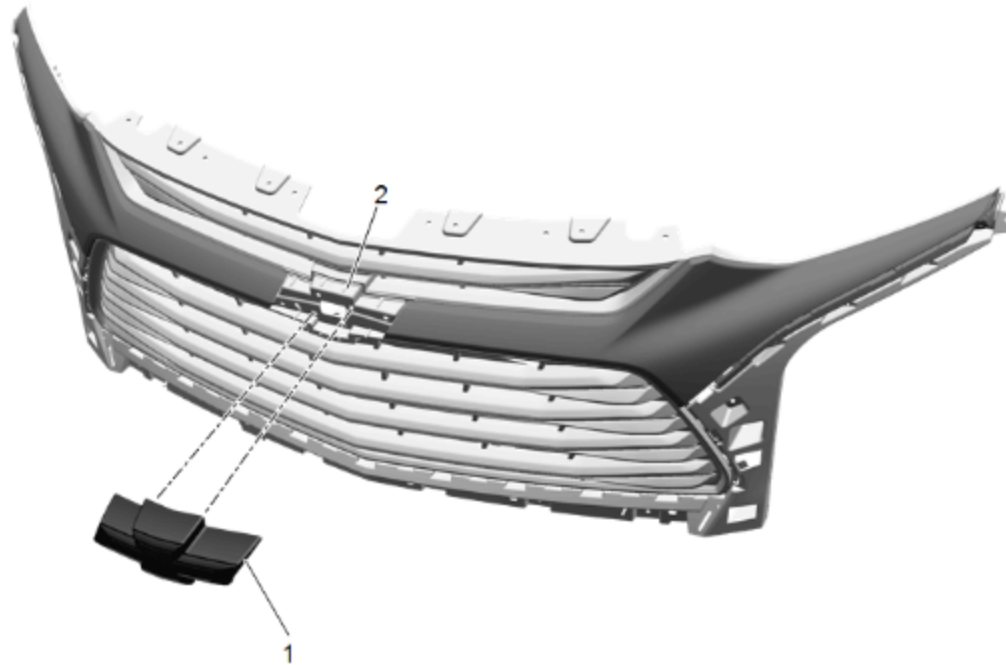

5. Install the grille insert emblem adaptor (1) to the front grille (2).

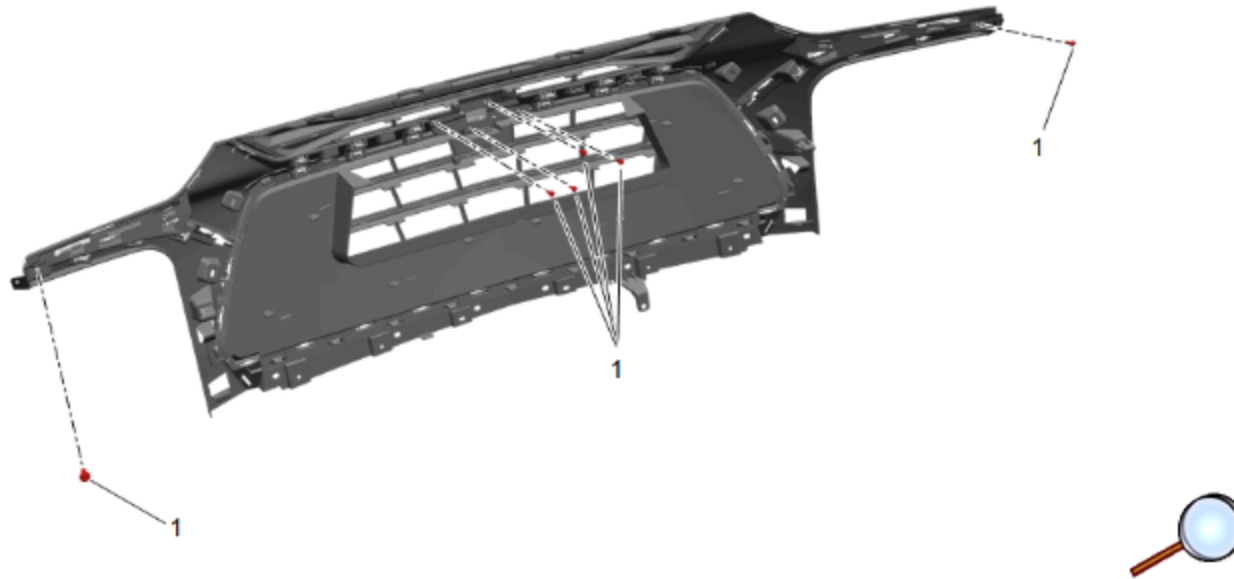

Caution: Use the correct fastener in the correct location. Replacement fasteners must be the correct part number for that application. Fasteners requiring replacement or fasteners requiring the use of thread locking compound or sealant are identified in the service procedure. Do not use paints, lubricants, or corrosion inhibitors on fasteners or fastener joint surfaces unless specified. These coatings affect fastener torque and joint clamping force and may damage the fastener. Use the correct tightening sequence and specifications when installing fasteners in order to avoid damage to parts and systems.

6. Install the previously retained screws (1) securing the production grille inserts to the grille. Tighten the screws to 2.5 N.m (22 lb in).
7. Reinstall the front bumper fascia grille. Refer to [Front Grille Replacement](#) in Vehicle Service Manual.